

मुंबई पत्तन प्राधिकरण
Mumbai Port Authority

(ISO 9001:2015) (ISO 14001:2015)
(ISO/IEC 27001:2013)

*Cruising towards a new era of
Cruise Tourism*

Mumbai International Cruise Terminal





**ENTRANCE TO
TERMINAL**

SITE 'BPX'

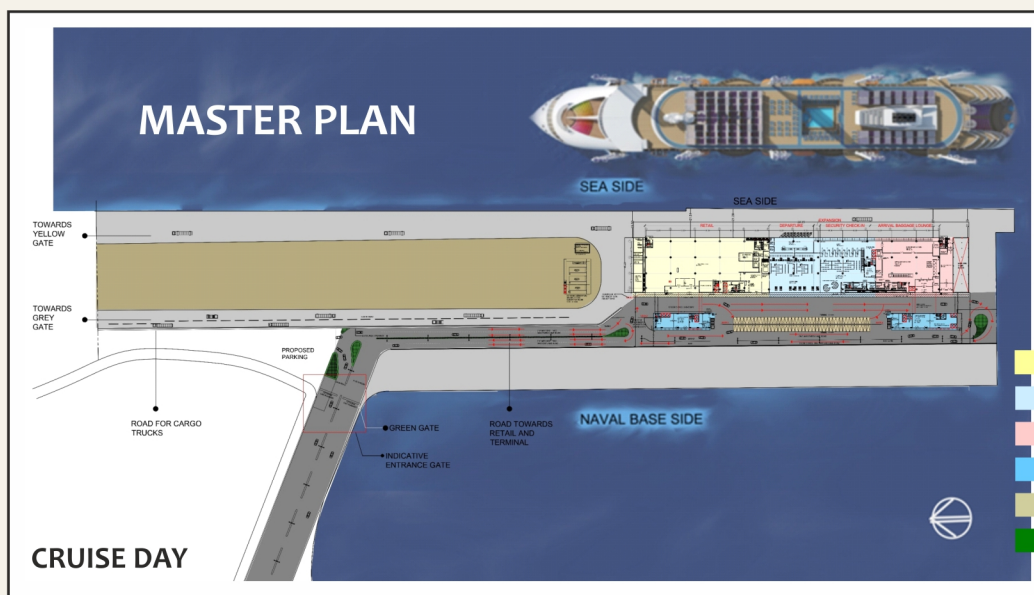

CRUISE DAY

Technical Features of New International Cruise Terminal

- Cruise ships up to 5000 Passengers
- 1 million per year Pax capacity
- Cruise Ship handled per annum = 200
- G+ 3 Structure Iconic Design on Cruise Concept
- Estimated Cost - 70 million USD (inclusive of PPP investment)
- Total Construction Area - 415,000 sq.ft.
- Total Operational Area - 170,000 sq.ft. (approx.)
- No of Days Operational - 365
- Facility open to local citizens for recreation, leisure and retail
- Draft available at Berth - 10.5 m
- Operation and Maintenance of Terminal on PPP Model

Key Project Benefits

- Mumbai Port projected to handle 80% of India's Cruise passengers
- Increase in domestic and international cruise tourists.
- Increased revenue to the port
- Overall growth for the local economy & employment
- World class iconic building added to Mumbai
- Opening of Mumbai Port Waterfront - For city
- Contribution of Mumbai Cruise Tourism
Economic Potential (Tax Allocated USD 4134.2 million)
Employment Potential - 200,000
- Mumbai will become Cruise Capital of India

FLOOR PLANS

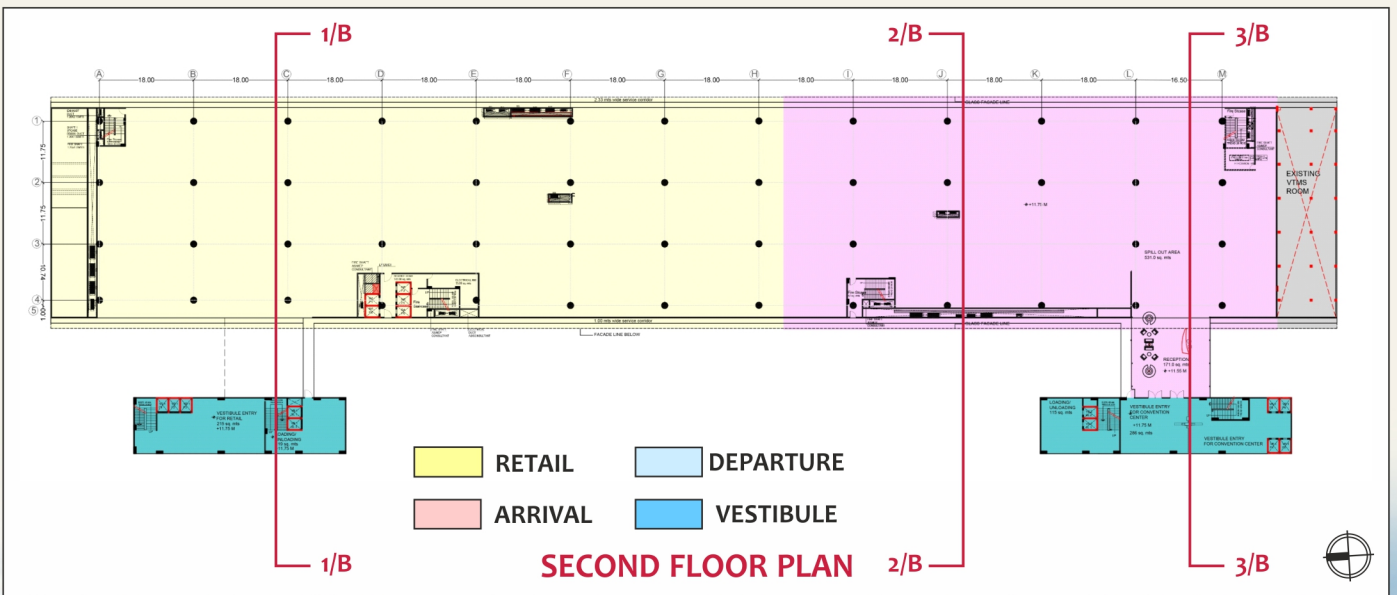
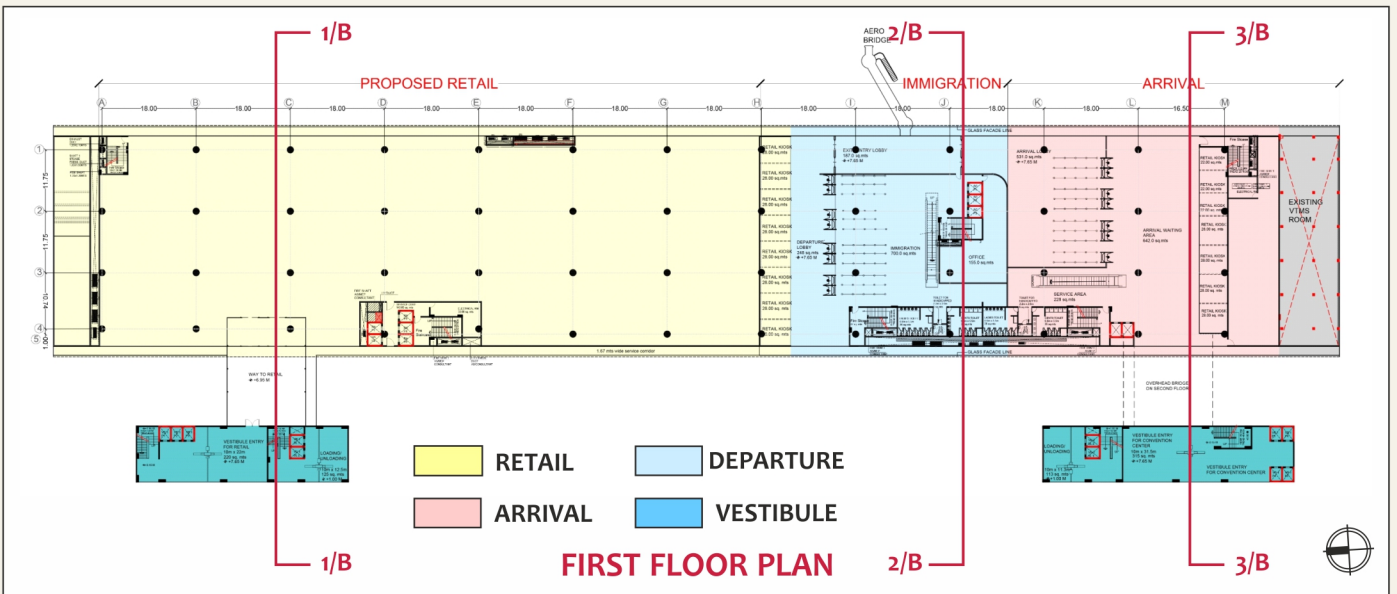
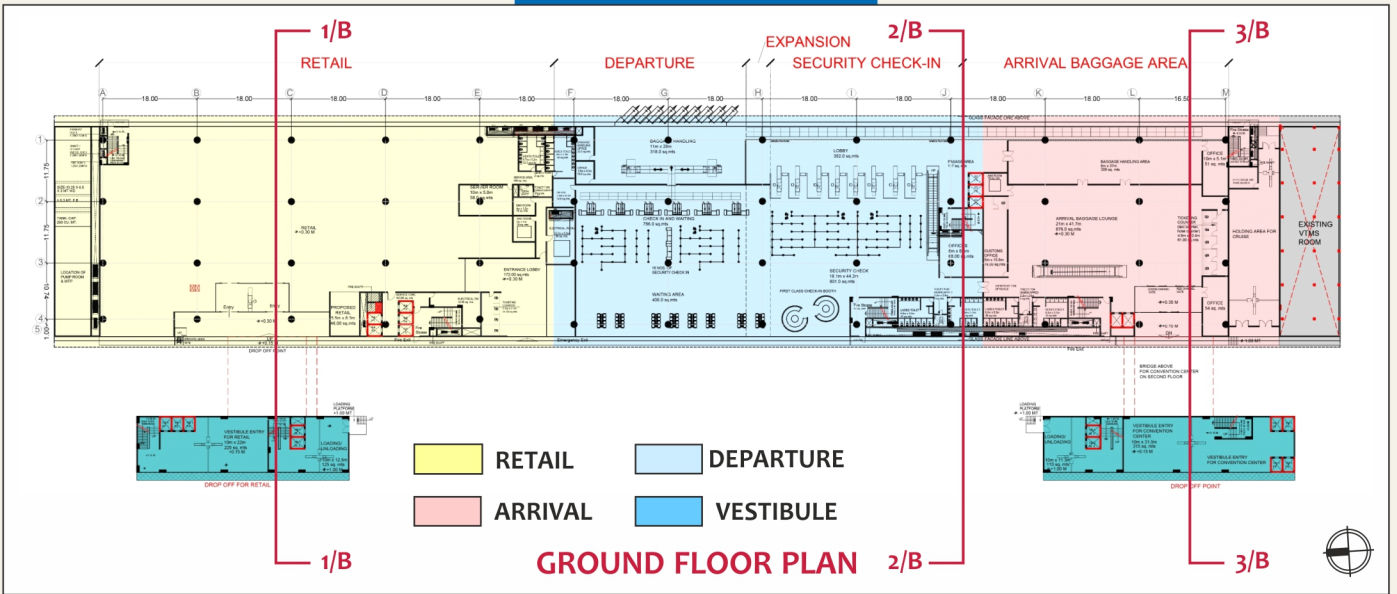

BA's Report and Action taken

	Existing (2016)	India's Potential (2041)	Potential of Mumbai (2041)
Number of Passengers	0.2 million	4 million	3.2 million
Number of Ship Calls	166	955	700
Passengers per Ship	1200	4100	4570
Economic Potential (Tax Allocated)	USD 103.67 million	USD 5168.94 million	USD 413.42 million
Employment Potential	5000	250000	200000

Measures Taken

- Guaranteed berths to cruise ships
- Ousting charges removed to attract more cruise vessels
- Uniform single rate for all major ports with discounts ranging from 42% to 67%
- e-Visa implemented enabling tourists to avail online and on-arrival visa facilities
- Single e-Landing card introduced, valid for all ports in cruise itinerary
- Cabotage waived for foreign cruise vessels on Indian shores benefiting Indian passengers
- Upgradation and Modernisation of Cruise Terminal with more passenger amenities and convenience
- Construction of new Cruise Terminals taken up
- Roadmap drawn for the development of Cruise in India by Ministry of Shipping
- A task force is setup, co-chaired by Secretary (Shipping) and Secretary (Tourism) by Govt. of India to steer the promotional measures for cruise tourism at highest level jointly with all Stakeholders - Ports, Immigration, Tourism Boards, Port Health, Customs, Taxation Body, Security, Cruise Operators, Tour Operators, Shipping Agents etc.
- Standard Operating Procedure (SOP-2) for uniform, pre-defined processes in Ports is implemented
- Volume Discount Scheme in Port tariff for Domestic Cruise Ships for calls exceeding 50 in a year
- Sensitization Training Programme arranged for all Cruise Stakeholders



MbPA Brochures



Developing India as Cruise Hub-MbPA



Sea Change MbPA



Miami Magical Voyage - MbPA



Miami - MbPA



Dawn of Cruise Tourism - MbPA



मुंबई पत्तन प्राधिकरण
Mumbai Port Authority

(ISO 9001:2015) (ISO 14001:2015)
(ISO/IEC 27001:2013)

Port House, Shoorji Vallabhdas Marg, Ballard Estate, Mumbai - 400 001. Tel: (022) 6656 5656

Nodal Officer for Cruise - Mr. Gautam Dey

Email: mbptcruise@mumbaiport.gov.in

www.mumbaiport.gov.in

www.shipping.nic.in



@mumbaiporttrust